

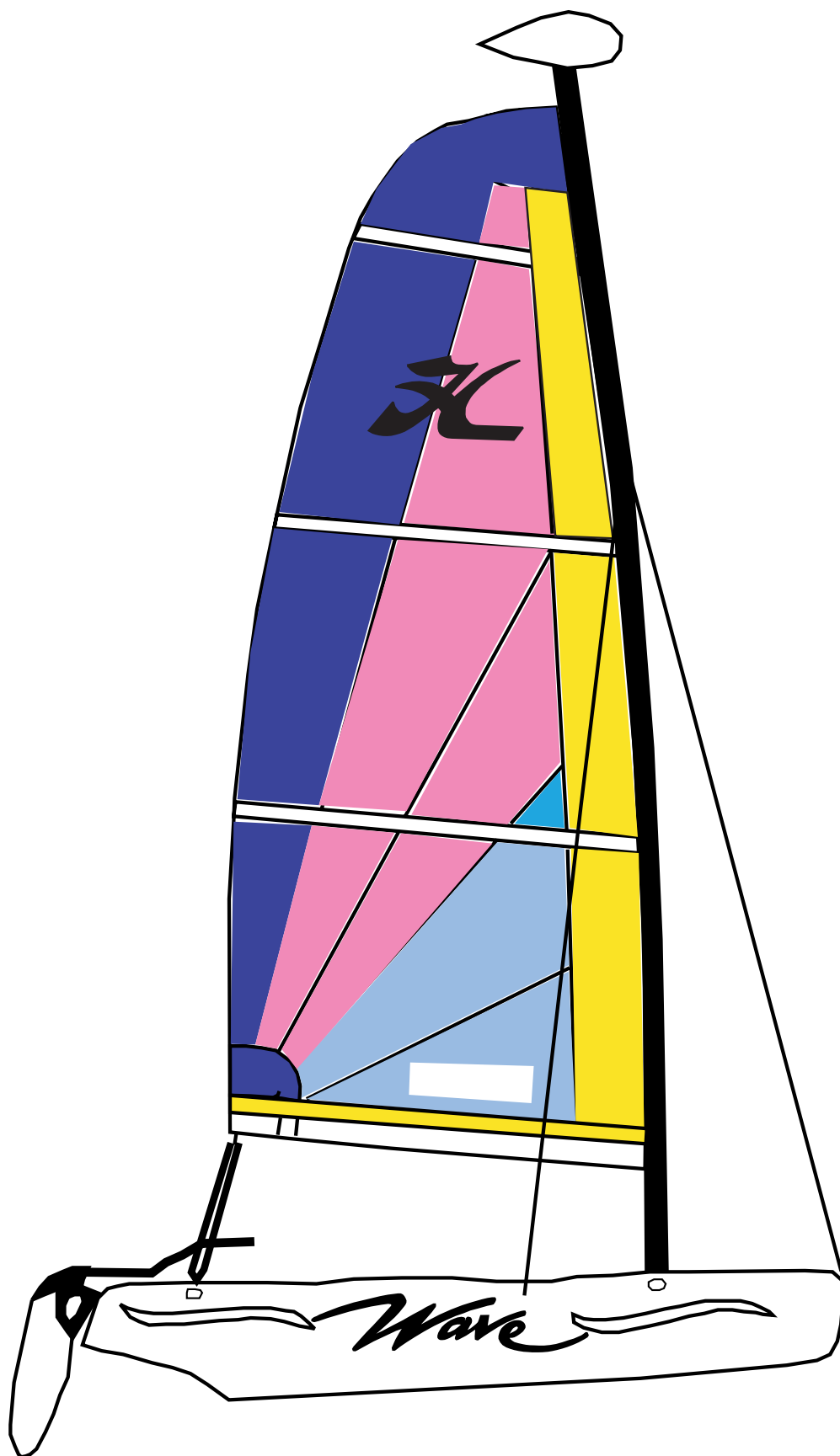

WAVE

Eclaté des pièces détachées

Illustrated Part Guide - Explosionszeichnung



HC WAVE Club

Coque/Hull/Rumpf

Coque complète/Complete hull/Rumpf komplett

99056122 : Gauche/Left/Links

99056121 : Droite/Right/Rechts

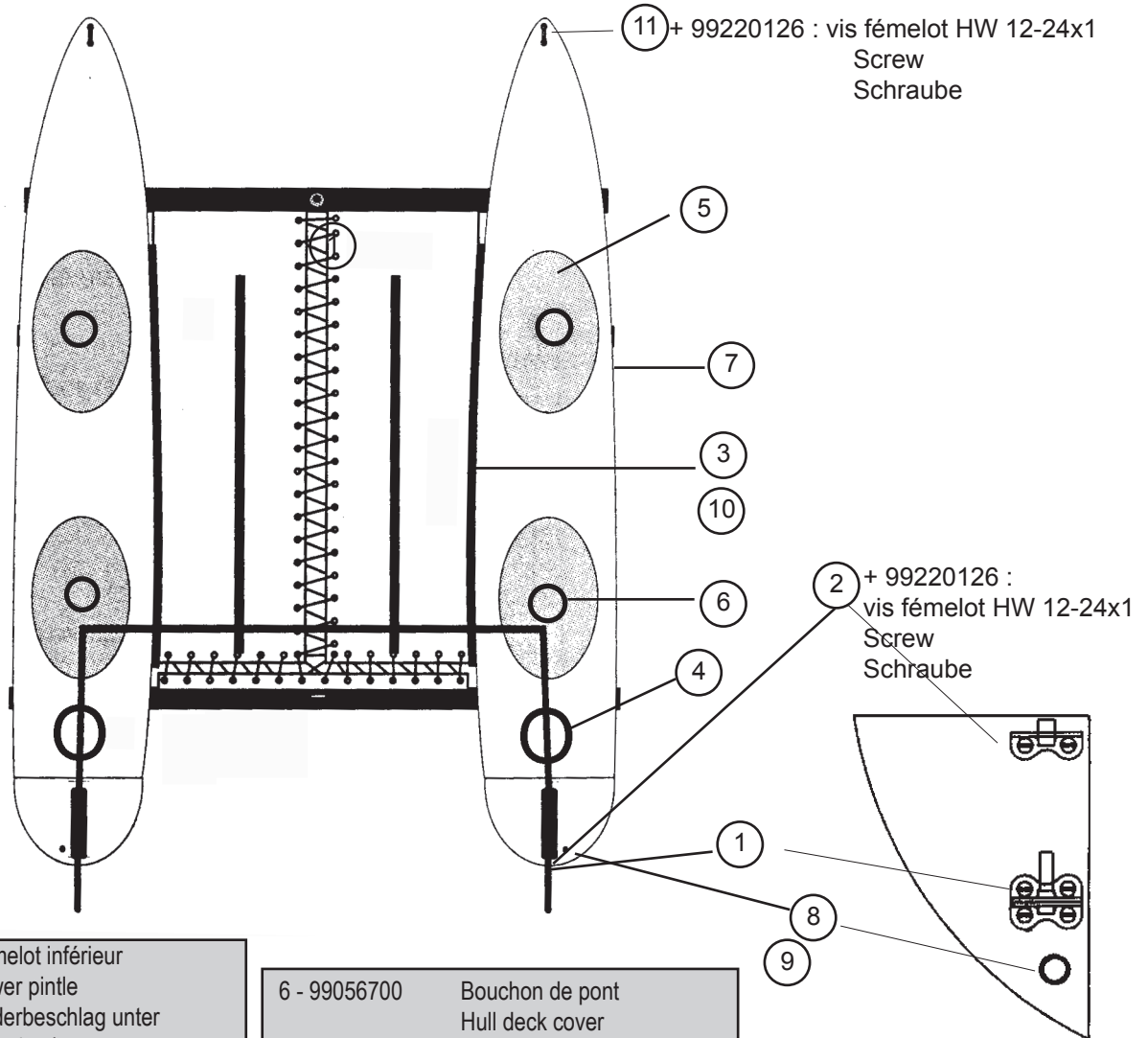

1 - 99056047 (2007)	Fémelot inférieur Lower pintle Ruderbeschlag unter
99061710 (2008)	Fémelot 4 trous Pintle 4 screws Ruderbeschlag 4 Schraube
2 - 99056048 (2007)	Fémelot supérieur Upper pintle Ruderbeschlag ober
99061705 (2008)	Fémelot 2 trous Pintle 2 screws Ruderbeschlag 2 Schraube
3 - 99056049	Rail de trampolin Trampoline track Trampolineschiene
4 - 18056033	Trappe de visite Inspection port cover Luckendeckel
5 - 99056705	Tapis antidérapant Seat pad Sukzbatte

6 - 99056700	Bouchon de pont Hull deck cover
7 - 99061400	Cadène de hauban Chain plate Putting
8 - 99220040 PKG 10	Bouchon de vidange Drain plug Ablaßschraube
9 - 99220041 PKG 10	Joint Gasket Dichtung
10 - 99220114	Vis rail de trampolin Screw trampoline track Schraube Trampolineschiene
11 - 14070323 PKG 10	Pontet Eyestraps Bügel

HC WAVE Club

Gouvernail/Rudder assembly/Ruderbeschlag

Gouvernail complet/Rudder assembly complete/
Ruderbeschlag komplett :

Droite/Right/Rechts = 99062115

Gauche/Left/Links = 99062110

2007

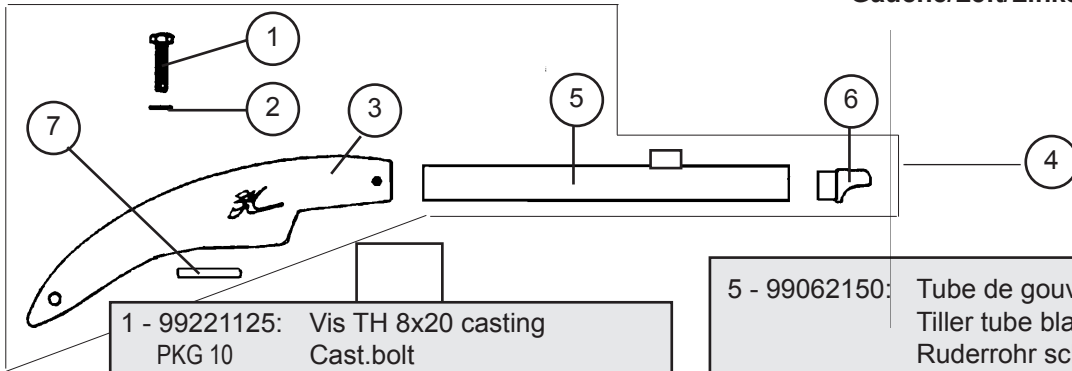

- 1 - 99221125: Vis TH 8x20 casting
PKG 10
Cast.bolt
Schraube Gußteil
- 2 - 99061110: Rondelle plate D8
PKG 10
Washer D8
Unterlegscheibe D8
- 3 - 17000010: Casting supérieur gouv.
Upper rudder casting
Oberes Rudergehäuse
- 4 - 99062121: Bras gouv.droit complet
Tiller arm right complete
Ruderarm rechts komplett
- 99062120: Bras gouv.gauche complet
Tiller arm left complete
Ruderarm links komplett

- 5 - 99062150: Tube de gouvernail nu noir
Tiller tube black bare
Ruderrohr schwarz
- 6 - 99000005 : Embout à rotule
Tiller end cap
Ruderarmendstück
- 7 - 14061122: Platine dural
Cam stop plate
Platine f. oberes Rudergehäuse
- 8 - 14061180 : Came safran
PKG 10
Plastic cam
Rudernock
- 9 - 16041755: Goupille élastique
PKG 10
Maststep pin
Sprengbolzen

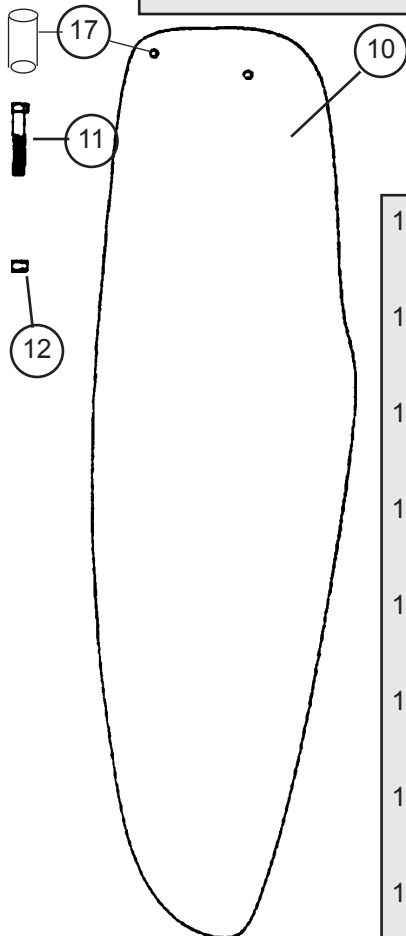

- 10 - 18062180 : Lame safran Lexan
Ruder blade Lexan
Ruderblatt Lexan
- 11- 99220150: Vis safran TH 8x55
PKG 10
Rudder bolt
Schraube Ruderblatt
- 12- 99220012: Ecrou indessérable D8
PKG 10
Nylstop nut
Selbstsichernde Mutter
- 13- 18000155: Casting inf. gouv
Lower rudder casting
Unteres Rudergehäuse
- 14- 14061105: Pene safran
PKG 10
Plunger
Gegenstück Rudernock
- 15- 99220004: Ressort inox
PKG 10
Spring
Feder
- 16- 99220006: Vis safran delrin
PKG 10
Tension screw
Delrinschraube
- 17- 99502160: Insert lame de safran
Sheave pin rudder blade
Bolzen Ruderblatt
- 18- 17062680 : Casting inf. gouv. monté
Lower rudder cast. assembly
Unteres Rudergehäuse montiert

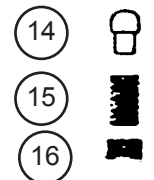
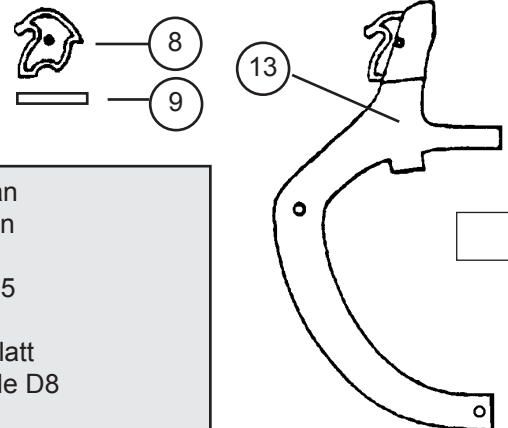

18

HC WAVE Club
Gouvernail/Rudder assembly/Ruderbeschlag
99062112

2008

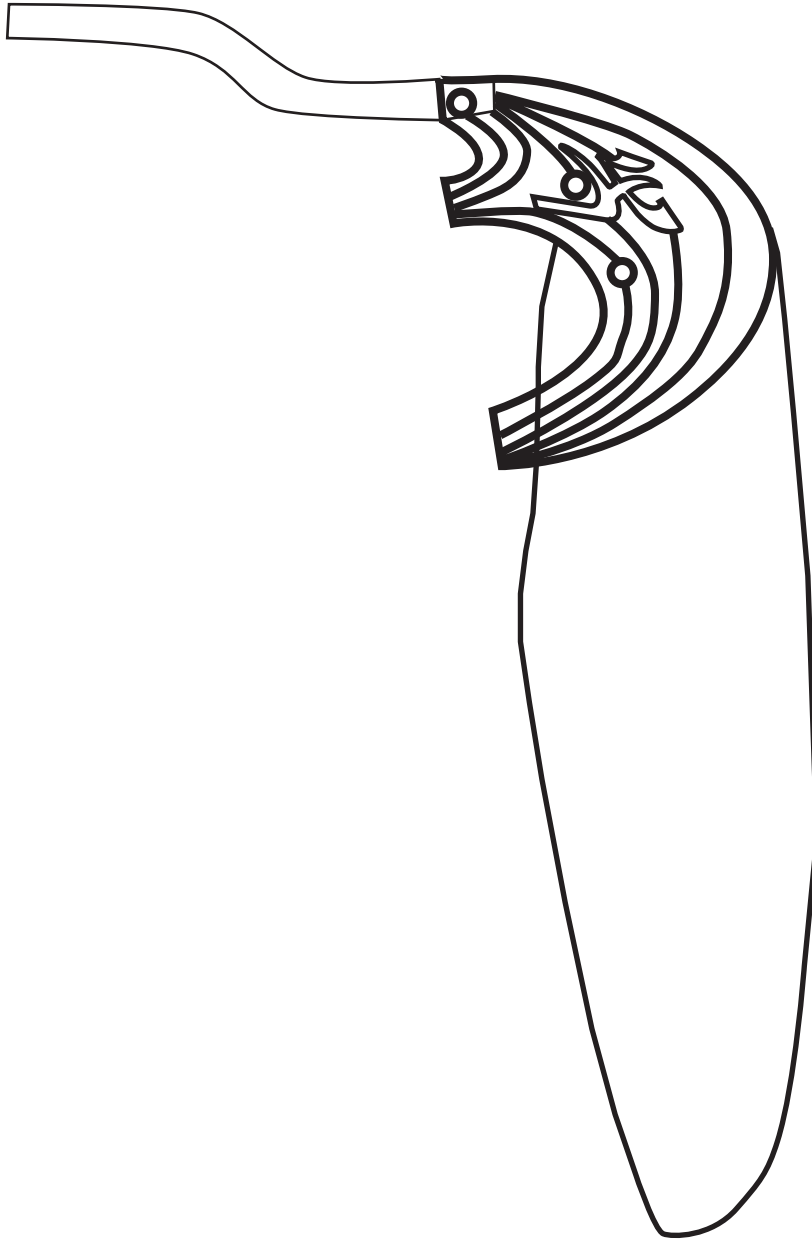

HC WAVE Club

Traverses/Crossbars/Holme

TRAVERSE AVANT/FRONT CROSSBAR/VORDERHOLM

99062610 (avant/prior/vor 2004)

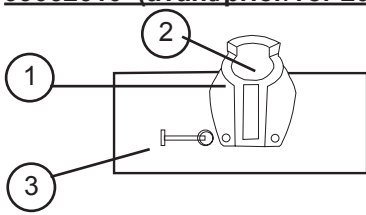

<p>1 - 14000025</p> <p>2 - 14041707 PKG 10</p> <p>3 - 16041755 PKG 10</p>	<p>Emplanture de mât Maststep Mastfusspfanne</p> <p>Coussinet Teflon Mast pivot bearing Teflonplättchen</p> <p>Axe + goupille Axe + cotter pin Achse + Sprengbolzen</p>
---	---

99062605 (2004)

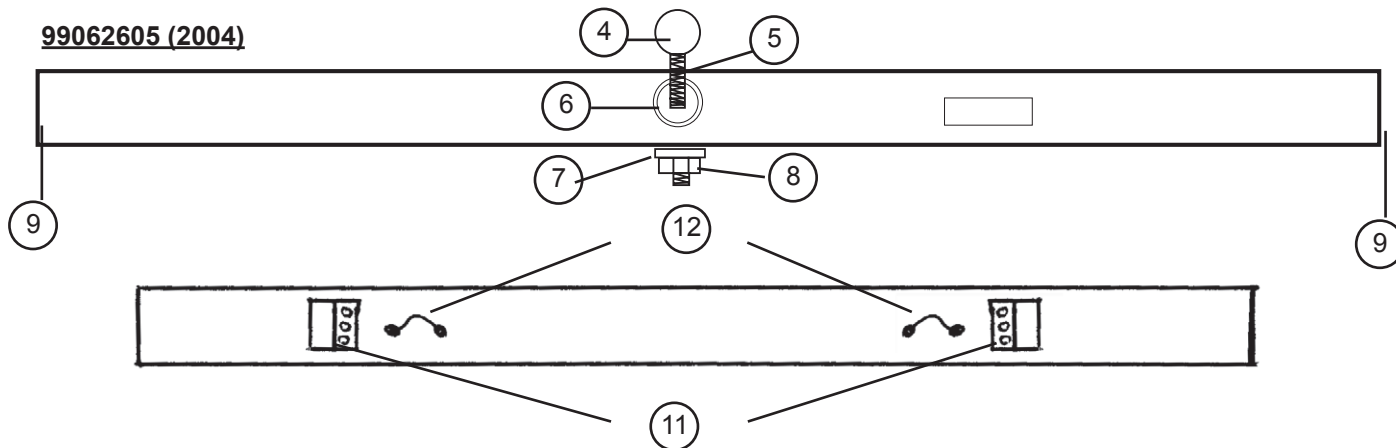

TRAVERSE ARRIERE/REAR CROSSBAR/ACHTERHOLM : 99062615

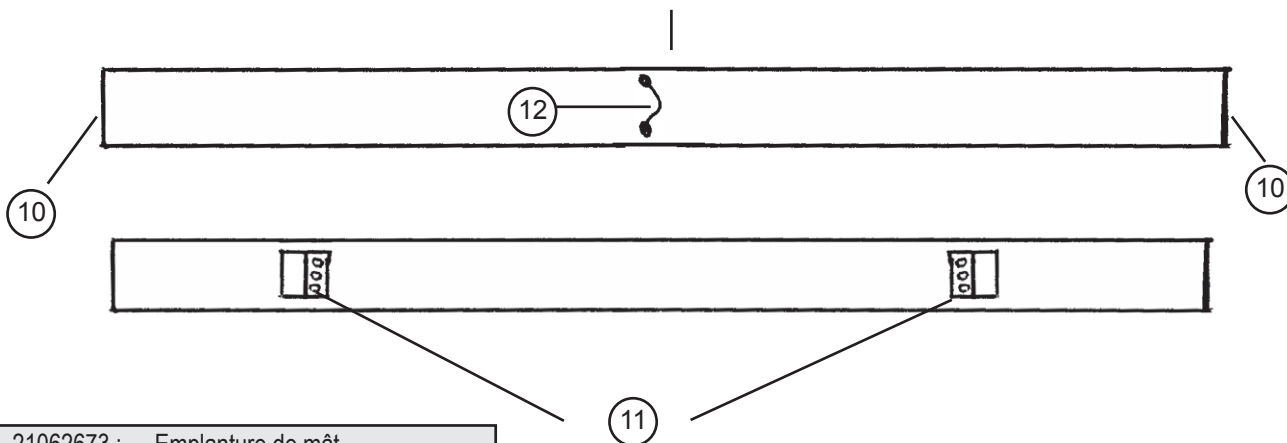

- | |
|---|
| <p>4 - 21062673 : Emplanture de mât
Mast step ball
Mastfussballe</p> <p>5 - 99219000 : Tige filetée M16
(mm) Mast step post
Mastfuss</p> <p>6 - 99220104 : Erou HU 16 mm
Nut HU 16 mm
Mutter HU 16 mm</p> <p>7 - 99220100 : Rondelle inox 16 mm
PKG 10 Washer stainless steel
Inox Scheibe</p> <p>8 - 99220110 : Erou indessérable 16 mm
Nylstop nut
Selbstsichernde Mutter</p> |
|---|

- | |
|--|
| <p>9 - 99056061 Bouchon traverse AV
Front crossbar end cap
Vorderholm-Endstück</p> <p>10 - 99056062 Bouchon de traverse AR
Rear crossbar end cap
Achterholm-Endstück</p> <p>11 - 99056530 Equerre d'arrêt traverse
Crossbar stop plate
Vorderholm-Arretierung</p> <p>12 - 99220215 Pontet
PKG 10 Eyestraps
Bügel</p> |
|--|

2007

HC WAVE Club

Barre d'accouplement renforcée & Stick
Tiller crossbar reinforced & Tiller extension
Anlenkstange verstärkt & Pinengelenk

BARRE ACCOUPLEMENT RENFORCEE COMPLETE/TILLER
CROSSBAR REINFORCED COMPLETE/ANLENKSTANGE
VERSTÄRKT KOMPLET = 99062260

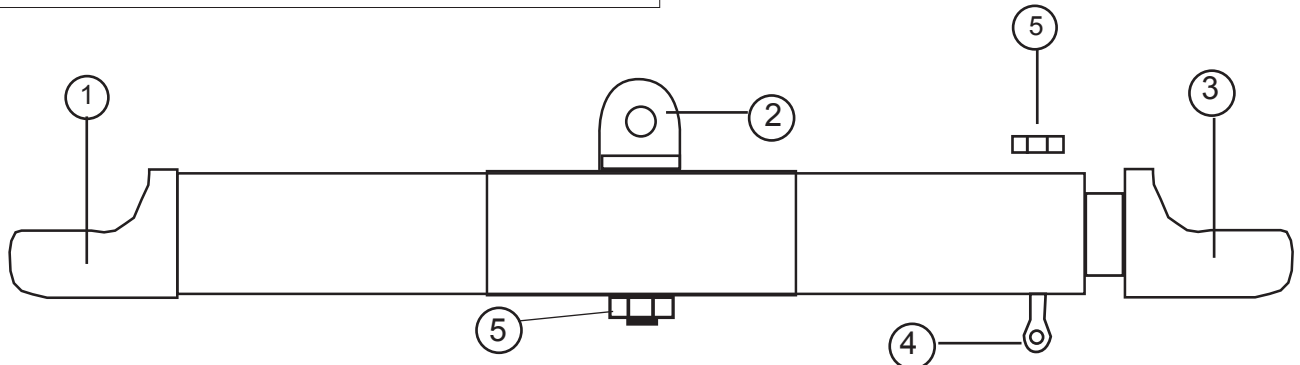

- | | |
|-------------------------|--|
| 1 - 99000005: | Embout à rotule
Tiller end cap
Pinnenendstück |
| 2 - 99221301:
PKG 4 | Vis violon
Violon screw
Schraube für Pinngelenk |
| 3 - 99000010: | Coulisseau réglable
Adjustable tiller end cap
Gleiter |
| 4 - 99220010:
PKG 10 | Vis manillon
Tiller adjusting screw
Schraube |
| 5 - 99220012:
PKG 10 | Ecrou indessérable D8
Nylstop nut D8
Selbstsichernde Mutter D8 |

- | | |
|--------------------------|---|
| 6 - 99500380: | Kit d'articulation TCM
Tiller connector kit TCM
Verbindungsgelenk TCM |
| 7 - 99500331: | Demi-pallier
Rubberspacer
Distanzhülse |
| 8 - 99220029:
PKG 20 | Demi-bille nylon
Half ball nylon
Nylon Halbkugel |
| 9 - 99500335:
PKG 10 | Ressort TCM
TCM spring
TCM-Feder |
| 10 - 99220027:
PKG 10 | Vis TH 6 x 50
TH screw
TH Schraube |
| 11 - 99220032:
PKG 10 | Rondelle inox
Stainless washer
Unterlegscheibe |
| 12 - 99220019:
PKG 10 | Ecrou indessérable D6
Nylstop nut D6
Selbstsichernde Mutter D6 |

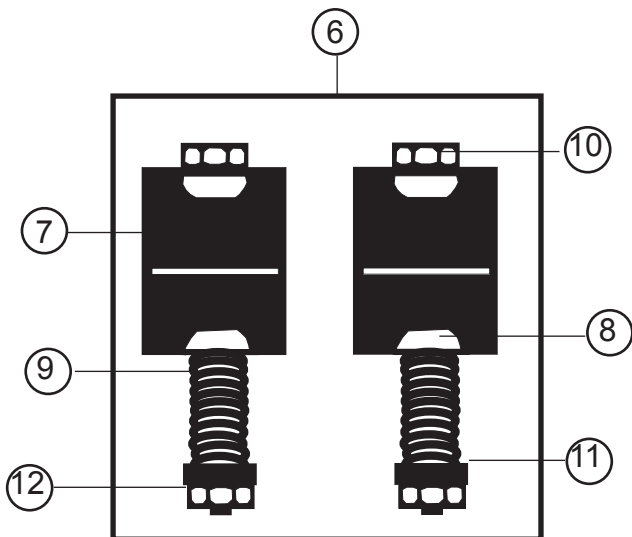

- | | |
|--------------------------|---|
| 13 - 99062305 : | Stick Alu
Aluminium tiller extension
Pinnenausleger Aluminium |
| 14 - 14061315:
PKG 10 | Embout stick alu
Aluminium extension cap
Pinnenendstück Aluminium |
| 15 - 14061320 :
PKG 2 | Chape articulation stick
Stick articulation |



2008

HC WAVE Club

Barre d'accouplement renforcée & Stick
Tiller crossbar reinforced & Tiller extension
Anlenkstange verstärkt & Pinengelenk

BARRE ACCOUPLEMENT RENFORCEE COMPLETE/TILLER
CROSSBAR REINFORCED COMPLETE/ANLENKSTANGE
VERSTÄRKT KOMPLET = 99062200

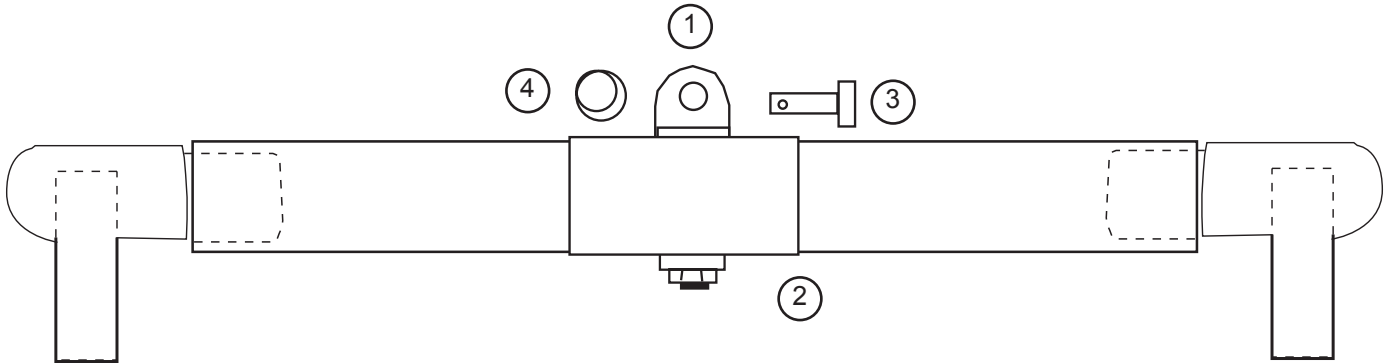

1 - 99221301: PKG 4	Vis violon Violon screw Schraube für Pinnengelenk
2 - 99220012: PKG 10	Ecrou indessérable D8 Nylstop nut D8 Siebstsichernde Mutter D8
3 - 14061240: PKG 10	Axe percé Clevis pin Bolzen
4 - 99220031: PKG 10	Anneau brisé Split ring Ring Splint
5 - 99062305 :	Stick Alu Aluminium tiller extension Pinnenausleger Aluminium
6 - 14061315: PKG 10	Embout stick alu Aluminium extension cap Pinnenendstück Aluminium
7 - 14061320 :	Chape articulation stick Stick articulation



HC WAVE Club
Mât/Mast/Mast

Avant/Prior/Vor 2004

Mât 1 pièce/1 piece Mast/Einteiliger Mast = **99042700**
Mât 2 pièces/2-piece mast /Zweiteiliger Mast = **99042710**

Jeux de câbles HW/Cable set/Käbelsatz = **99070500**
Sac d'accastillage/Rig bag/Takelagesack = **99080300**

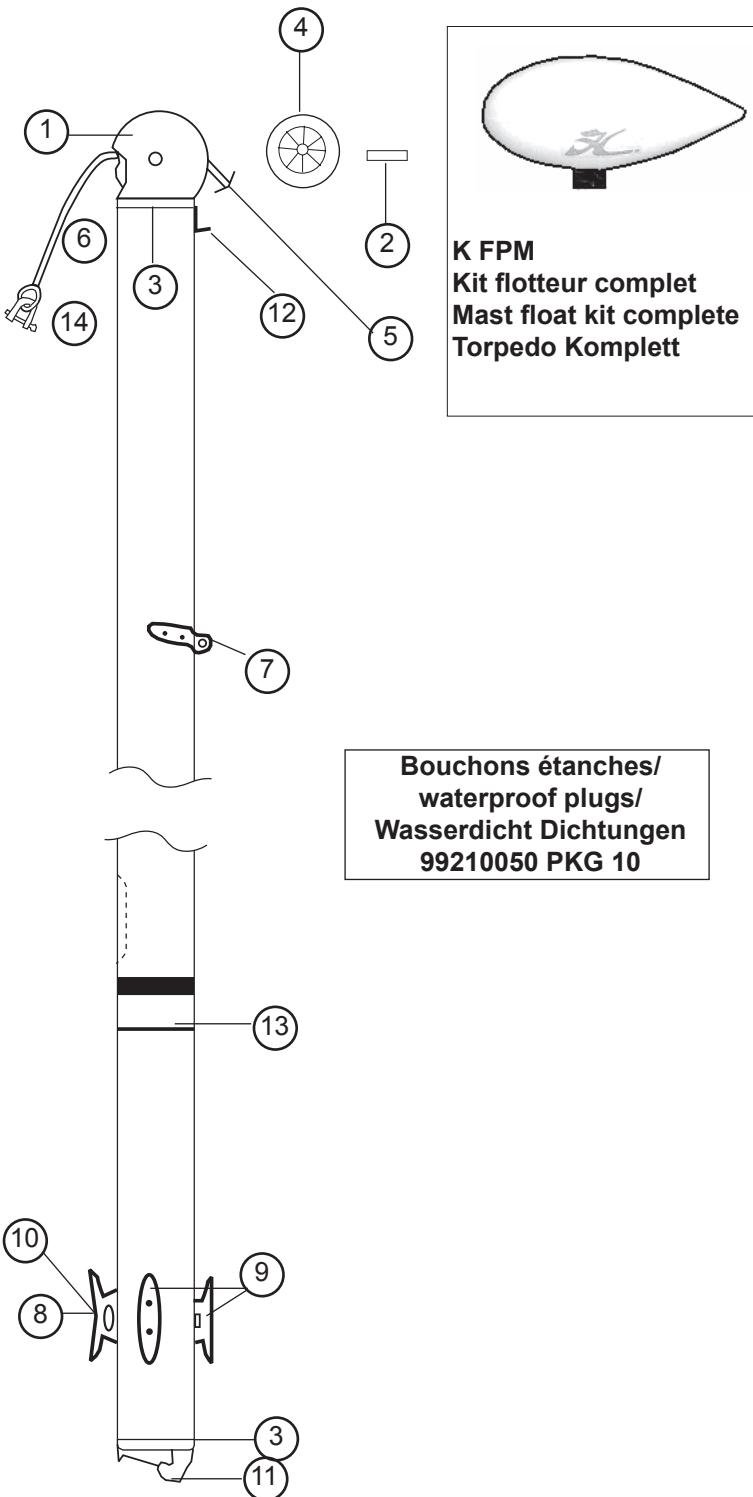

K FPM
Kit flotteur complet
Mast float kit complete
Torpedo Komplet

**Bouchons étanches/
waterproof plugs/
Wasserdicht Dichtungen**
99210050 PKG 10

- | | | |
|-----|------------|---|
| 1- | 14000015: | Tête de mât noire
Black mast head
Mastkopf schwarz |
| 2- | 14041711: | Axe tête de mât
Sheave pin mast head
Bolzen Mastkopf |
| 3- | 14042720: | Sceau mât
Mast plug
Mast Abdichtung |
| 4- | 14041712: | Réa
Nylon sheave
Rolle |
| 5- | 13041751: | Drisse câble GV
Main halyard wire
Grossfall Kabel |
| 6- | 14070460: | Drisse cordage
Halyard rope
Fall |
| 7- | 14041722: | Ferrure capelage
Mast tang
Mastbeschlag |
| 8- | 14041715 : | Taquet étarq amure
PKG 10 Downhall cleat
Klampe |
| 9- | 99220050 : | Taquet de drisse
PKG 10 Halyard Cleat
Niederholer Mastklemme |
| 10- | 99220051 : | Vis taquet
PKG 10 Screw
Schraube |
| | 99220325 | Ecrou carré amure
Tack square nut
Viereckmutter |
| 11- | 14000020 : | Base mât noire
Black mast base
Mastfuss schwarz |
| 12- | 14041721 : | Hook de drisse
Halyard hook
Fallhaken |
| 13- | 14041723: | Autocollant de sécurité
Mast caution label
Sicherheitsaufkleber |
| 14- | 99220035 : | Manille 6 mm
PKG 10 Shackle 5 mm
Schäkel 6 mm |

HC WAVE Club Mât/Mast/Mast

2004

Mât 1 pièce/1 piece Mast/Einteiliger Mast = **99042705**
Mât 2 pièces/2-piece mast /Zweiteiliger Mast = **99042715**

Jeux de câbles HW/Cable set/Käbelsatz = **99070502**
Sac d'accastillage/Rig bag/Takelagesack = **99080300**

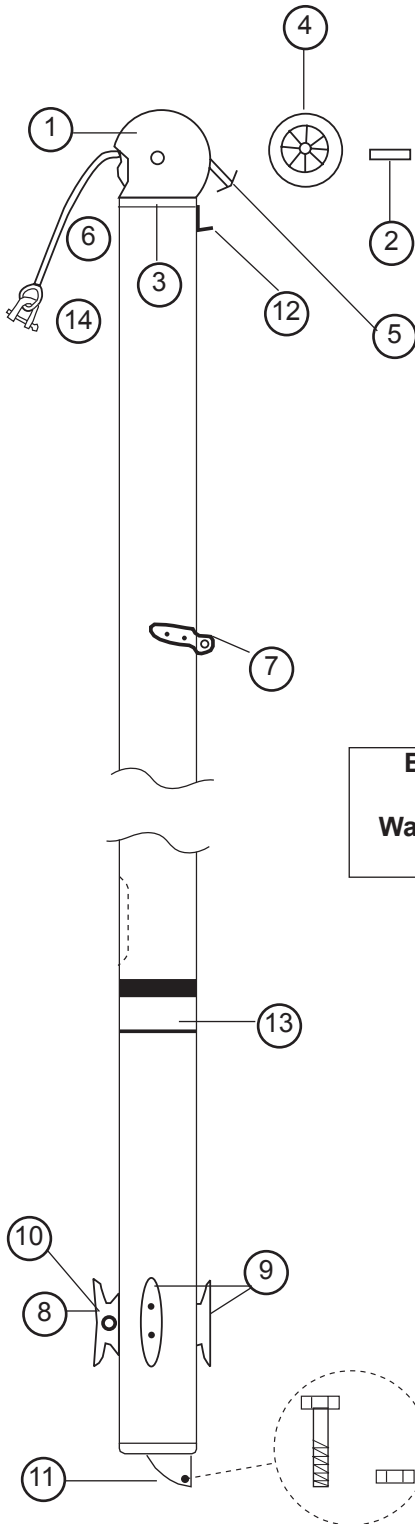

K FPM
Kit flotteur complet
Mast float kit complete
Torpedo Komplet

**Bouchons étanches/
waterproof plugs/
Wasserdicht Dichtungen**
99210050 PKG 10

- | | | |
|-----|------------|---|
| 1- | 14000015: | Tête de mât noire
Black mast head
Mastkopf schwarz |
| 2- | 14041711: | Axe tête de mât
Sheave pin mast head
Bolzen Mastkopf |
| 3- | 14042720: | Sceau mât
Mast plug
Mast Abdichtung |
| 4- | 14041712: | Réa
Nylon sheave
Rolle |
| 5- | 13041751: | Drisse câble GV
Main halyard wire
Grossfall Kabel |
| 6- | 14070460: | Drisse cordage
Halyard rope
Fall |
| 7- | 14041722: | Ferrure capelage
Mast tang
Mastbeschlag |
| 8- | 14041715 : | Taquet étarq amure
PKG 10 Downhall cleat
Klampe |
| 9- | 99220050 : | Taquet de drisse
PKG 10 Halyard Cleat
Niederholer Mastklemme |
| 10- | 99220051 : | Vis taquet
PKG 10 Screw
Schraube |
| | 99220325 | Ecrou carré amure
Tack square nut
Viereckmutter |
| 11- | 13600010 : | Base mât 2004
Mast base 2004
Mastfuss 2004 |
| 12- | 14041721 : | Hook de drisse
Halyard hook
Fallhaken |
| 13- | 14041723: | Autocollant de sécurité
Mast caution label
Sicherheitsaufkleber |
| 14- | 99220035 : | Manille 6 mm
PKG 10 Shackle 6 mm
Schäkel 6 mm |

HC WAVE Club

Haubans/Shrouds/Wanten

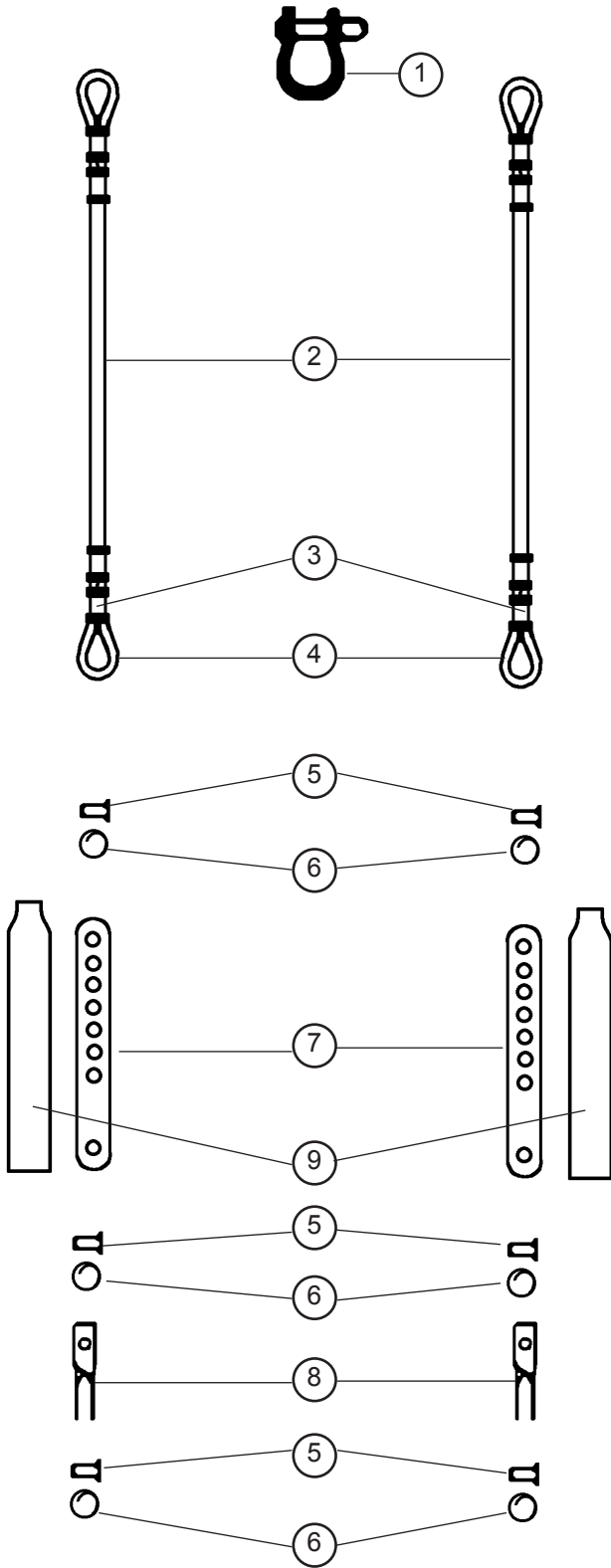

1-99220058: PKG 10	Manille Lyre 8mm Shackle 8 mm Mastschäkel 8 mm
2- 99060515 (2003): 99060520 (2004)	Hauban Shroud Want
3- 99300140: PKG 10	Manchon D4 Sleeve Hülse
4- 99300053: PKG 10	Cosse std Thimble Kausch Std
5- 99220034: PKG 10	Axe percé lat.ridoir Clevis pin Bolzen für Wanteisen
6- 99220031: PKG 10	Anneau brisé Split ring Ringsplint
7- 99220033: PKG 5	Latte universelle ridoir Stay adjuster Wanteisen
8- 16060312: PKG 10	Chape de hauban Toggle Wanten Toggle
9- 99500360: PKG 10	Protège lattes ridoires Shroud adjuster cover Wantenschutz

HC WAVE Club

Etai & brides/Forestay and bridles/Vorstag und Hahnepot

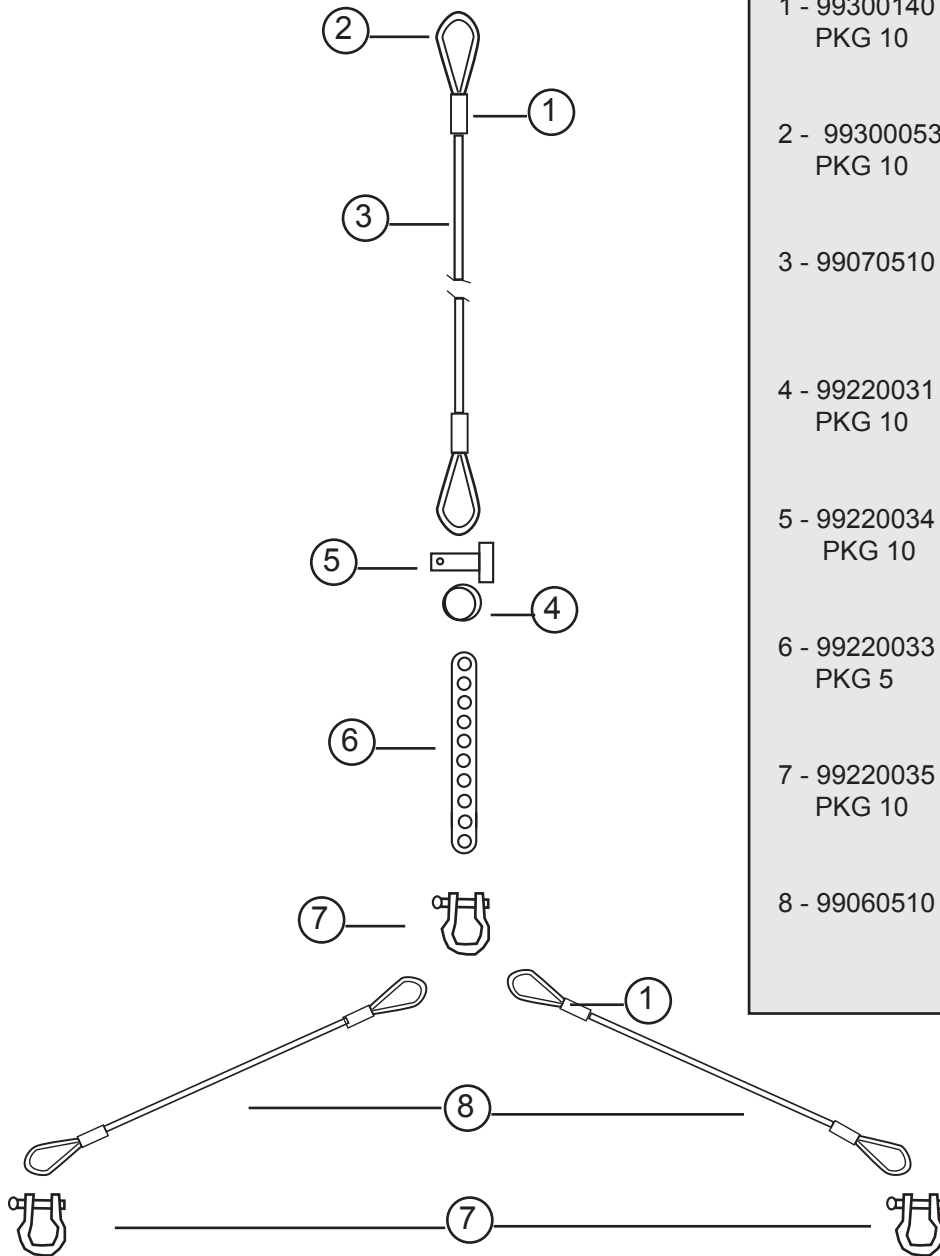

- | | |
|----------------|------------------------------------|
| 1 - 99300140 : | Manchon D4 |
| PKG 10 | Sleeve
Hülse |
| 2 - 99300053 : | Cosse std |
| PKG 10 | Thimble
Kausch Std |
| 3 - 99070510 : | Etai cable |
| | Forestay
Vorstag Kabel |
| 4 - 99220031 : | Anneau brisé |
| PKG 10 | Split ring
Ringsplint |
| 5 - 99220034 : | Axe percé |
| PKG 10 | Clevis pin
Bolzen für Locheisen |
| 6 - 99220033 : | Latte universelle |
| PKG 5 | Stay adjuster
Locheisen |
| 7 - 99220035 : | Manille lyre 6 mm |
| PKG 10 | Shackle 6 mm
Schäkel 6 mm |
| 8 - 99060510 : | Bride |
| | Bridle
Hahnepot |

HC WAVE Club
Trampolin/Trampoline/Trampolin

Avant/Front/Vorder

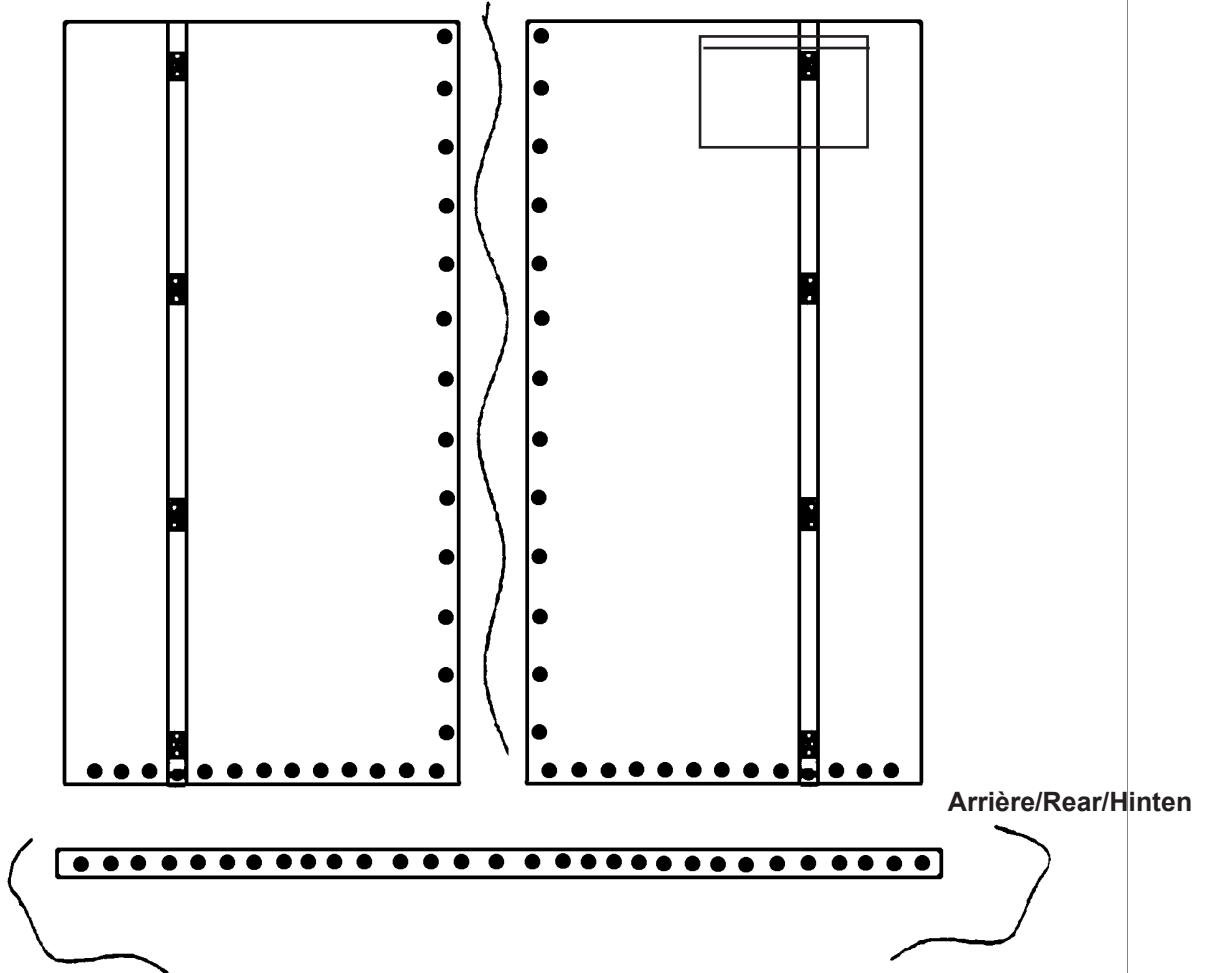

TRAMPOLIN 3 PIECES/3 PIECE TRAMPOLINE/3TEILIGER TRAMPOLIN
99025005 blanc/white/weiss
99025215 Bleu/blue/blau

HC WAVE Club
Grand-voile/Main sail/Gross-Segel

16990001	Grand-voile HC Wave blanche HC Wave white mainsail HC Wave Großsegel weiß
16990002	Grand-voile HC Wave couleur HC Wave coloured mainsail HC Wave Großsegel farbig
99034010	Jeu de lattes HC Wave HC Wave batten set HC Wave - Lattensatz
99070400	Sac de cordage GV + trampoline Rope bag mainsail and trampoline Linetasche für Großsegel u. trampoline

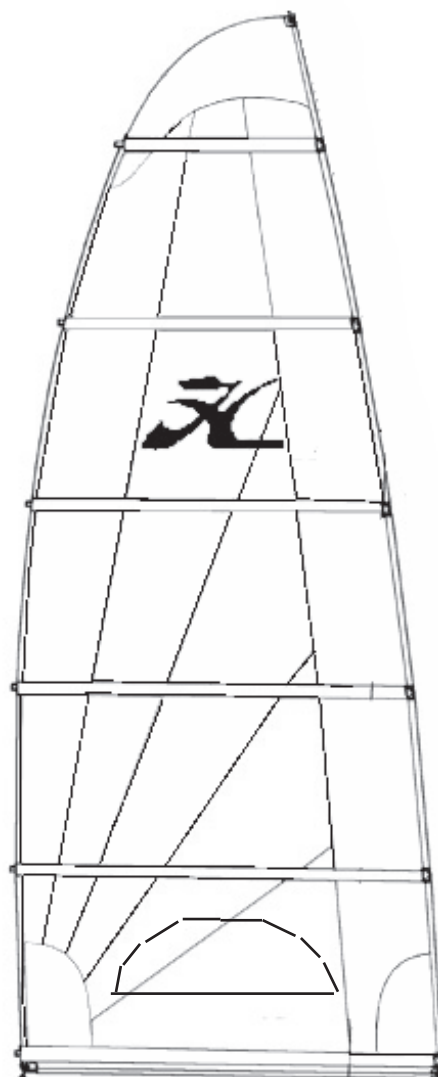

HC WAVE Club
Poulies/Main blocks/Blöcke

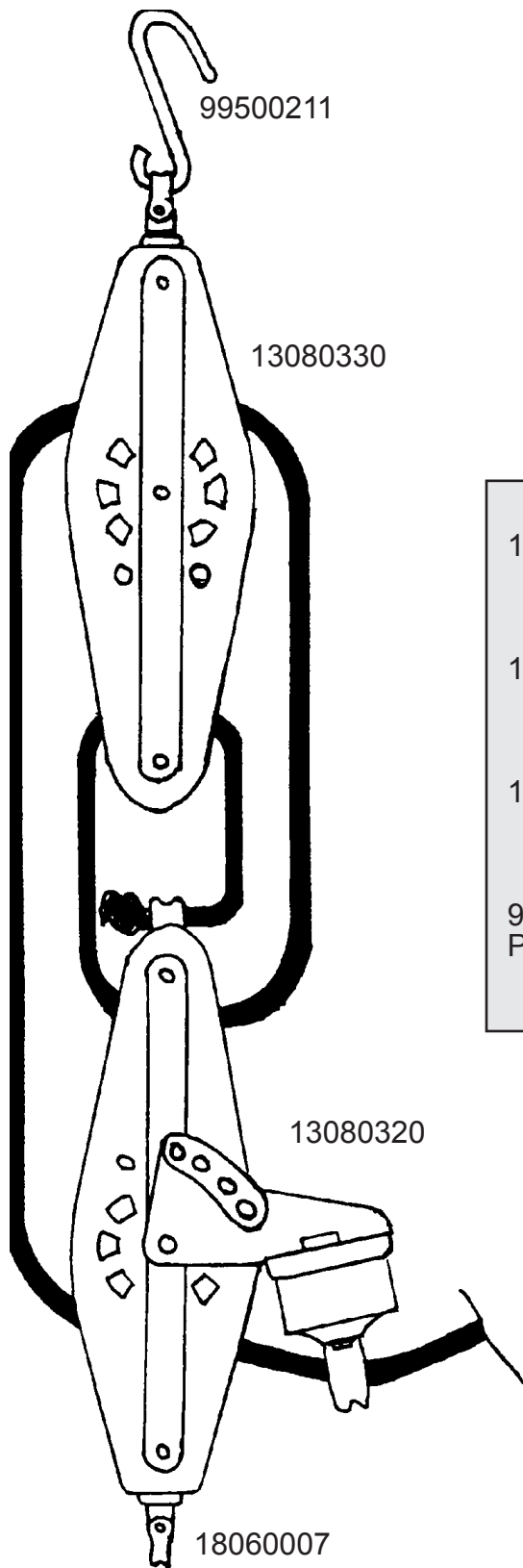

13080320	Poulie grand voile avec taquet Main block with cam cleat Block Gross-Segel mit Klemme
13080330	Poulie grand voile avec émerillon Main block with swivel Block Gross-Segel mit Wirbel
18060007	Manille de poulie Block shackle Blockschäkel
99500210 PKG 2	Crochet grand voile Main hook Großsegel Haken

HC WAVE club Turbo

Kit de foc - Jib Kit - Fockkit

99600045

- | | |
|----------------|---|
| 1 - 99300140 : | Manchon D4 |
| PKG 10 | Sleeve
Hülse |
| 2 - 99300053 : | Cosse std |
| PKG 10 | Thimble
Kausch Std |
| 3 - 99070520 | Estrope
Pigtail
Pigtail |
| 4 - 18042710 : | Manille longue |
| PKG 5 | Long shackle
Länge Schäkel |
| 5 - 99500250 : | Poulie drisse de foc |
| | Jib halyard block
Fockfallumlenblock |
| 6 - 99220036 : | Manille lyre 4 mm |
| PKG 10 | Shackle 4 mm
Schäkel 4 mm |
| 7 - 99080010 : | Tourelle de foc gauche + support |
| | Jib block +plate left
Fockschotsblock mit Platte links |
| 99080015 : | Tourelle de foc droite+ support |
| | Jib block +plate right
Fockschotsblock mit Platte rechts |

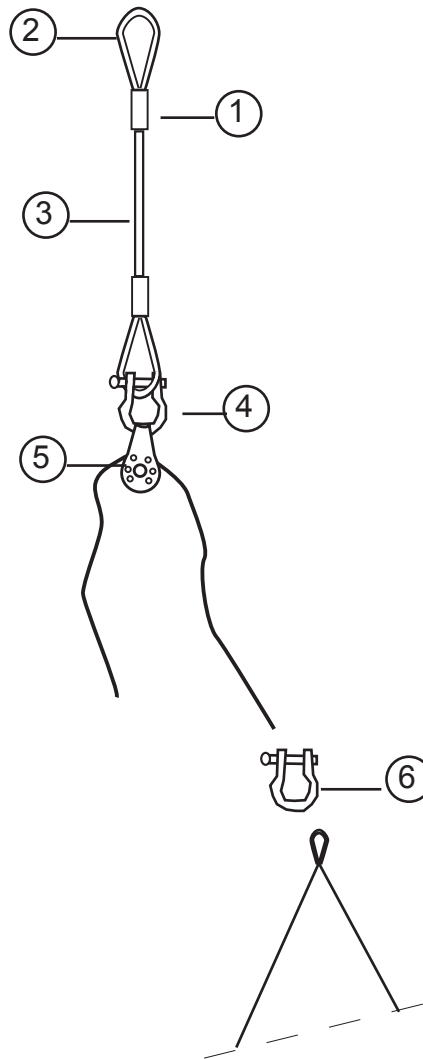

sur les coques/on the hulls/auf der Rümpfe

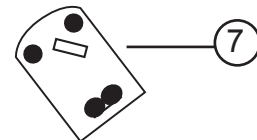

- 16990005 : Foc blanc/White jib/Fock weiss
16990010 : Foc couleur/Coloured jib/Fock farbig

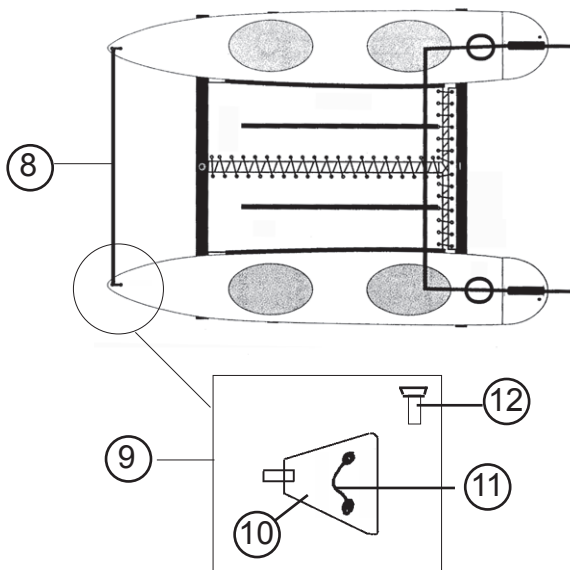

- | | |
|---------------|--|
| 8 - 99062320 | Barre de maintien parallèle |
| | Parallel bow spreader bar
Holm Turbo |
| 9 - 99062330 | Embout barre de maintien |
| | Parallel bar end cap
Turbo Holm-Endstück |
| 10 - 99056520 | Platine barre de maintien |
| | Plate for parallel bow spreader bar
Platte Holm Turbo |
| 11 - 99220145 | vis platine |
| PKG 10 | plate screw
Platte-Schraube |
| 12 - 99220216 | Pontet |
| PKG 5 | Eyestay
Bügel |